

HONDA

BIG RED 300

x4

BIG RED 300

4 x 4

T/L

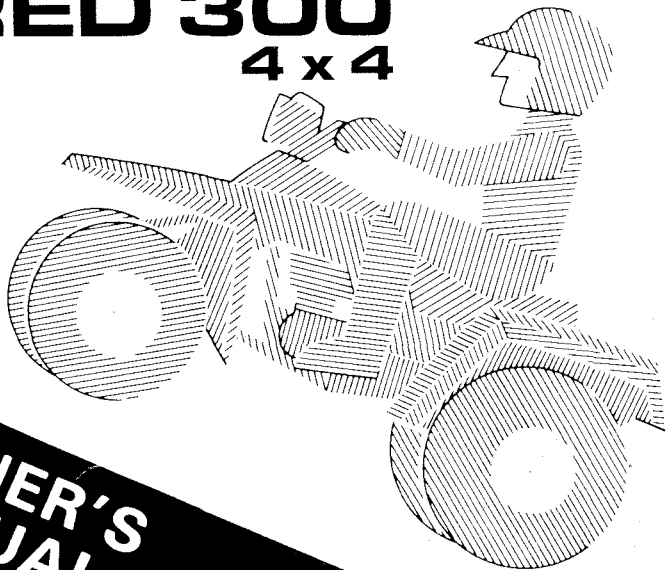

**OWNER'S
MANUAL**

IMPORTANT NOTICE

- **OPERATOR ONLY. NO PASSENGERS.**

This vehicle is designed and constructed as an operator-only model. The vehicle load limit and seating configuration do not safely permit the carrying of a passenger.

- **OPERATOR AGE RECOMMENDATION.**

The recommended rider age for this ATV is age 16 or older.

- **FOR OFF ROAD USE ONLY.**

This vehicle is designed and manufactured for off road use only.

- **READ THIS OWNER'S MANUAL CAREFULLY.**

Pay special attention to statements preceded by the following words:

▲ WARNING

Indicates a strong possibility of severe personal injury or death if instructions are not followed.

CAUTION:

Indicates a possibility of personal injury or equipment damage if instructions are not followed.

NOTE: Gives helpful information.

This manual should be considered a permanent part of the BIG RED and should remain with the BIG RED when resold.

HONDA TRX 300 FW
BIG RED 300 x4
OWNER'S MANUAL
HONDA TRX 300 FW
BIG RED 300 4x4
OWNER'S MANUAL

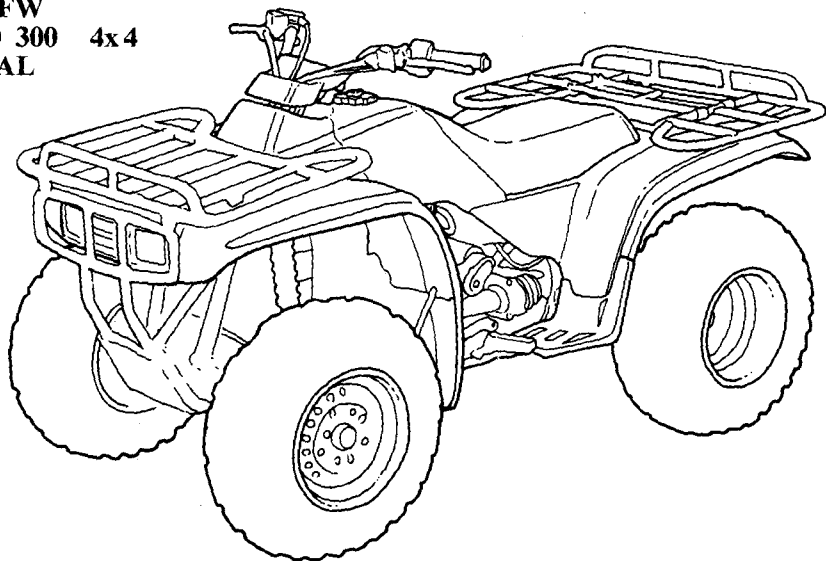

All information in this publication is based on the latest product information available at the time of approval for printing. HONDA MOTOR CO., LTD. reserves the right to make changes at any time without notice and without incurring any obligation.

No part of this publication may be reproduced without written permission.

//////////////////////. PREFACE ////////////////////////

This booklet is your guide to the basic operation and proper maintenance of your new Honda BIG RED. Please take the time to read it carefully. Details necessary for riding the Honda BIG RED are given to acquaint the new owner with special riding techniques to be learned. When service is required, remember that your Honda dealer knows your vehicle best. If you have the required mechanical "know-how" and tools, your dealer can supply you with an official Honda Service Manual to help you perform many maintenance and repair tasks.

Thank you for selecting a Honda. We wish you continued riding pleasure in the miles ahead.

NOTE:

* When reference to the right or left side of the vehicle is made, it is determined from the rider's view.

////////////////////////////////////CONTENTS////////////////////////////////////

	Page		Page
BIG RED SAFETY	1	Tool Kit	49
Safe Riding Rules	4	Fuel Filter Screen	50
Protective Apparel	4	Throttle Operation	51
Modifications	4	Air Cleaner	52
Post-Ride Cleaning and Inspection	5	Air Cleaner Case Drain Tube	53
Loading and Accessories	5	Spark Plug	54
DESCRIPTION	7	Valves	55
Parts Location	7	Engine Oil and Filter	57
Serial Numbers	9	Carburetor Choke	58
Parts Function	10	Carburetor	59
Fuel	21	High Altitude	60
Engine Oil	24	Gear Case Oil	62
Tyres	26	Final Drive Oil	63
Battery	28	Brakes	64
OPERATION	29	Clutch	69
Pre-Ride Inspection	29	Reverse Engagement Lever	70
Starting the Engine	30	Engine Guard and Skid Plates	70
Running-in	34	Driveshaft Boots	71
Riding	35	STORAGE GUIDE	72
Parking	46	TRANSPORTING	74
MAINTENANCE	47	SPECIFICATIONS	77
Maintenance Schedule	47	WIRING DIAGRAM	78
Maintenance Precautions	49		

////////////////////// **BIG RED SAFETY** ////////////////////////

Read this WARNING INFORMATION before you ride!

FRONT CARRIER WARNING LABEL

SAFETY INFORMATION WARNING LABEL

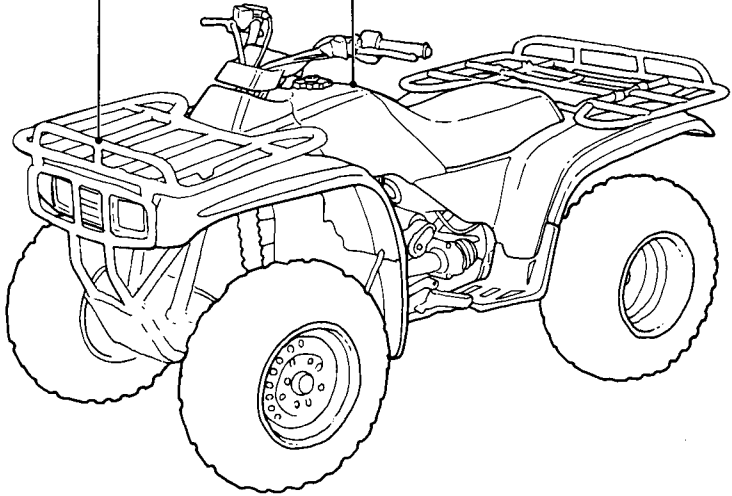

OPERATOR WARNING LABEL

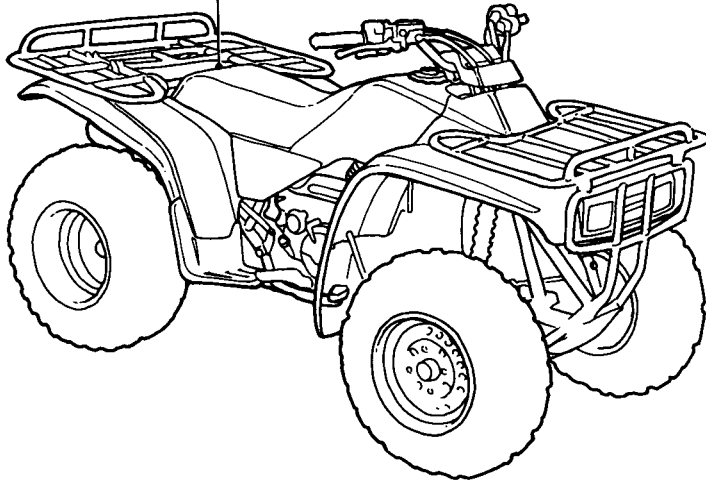

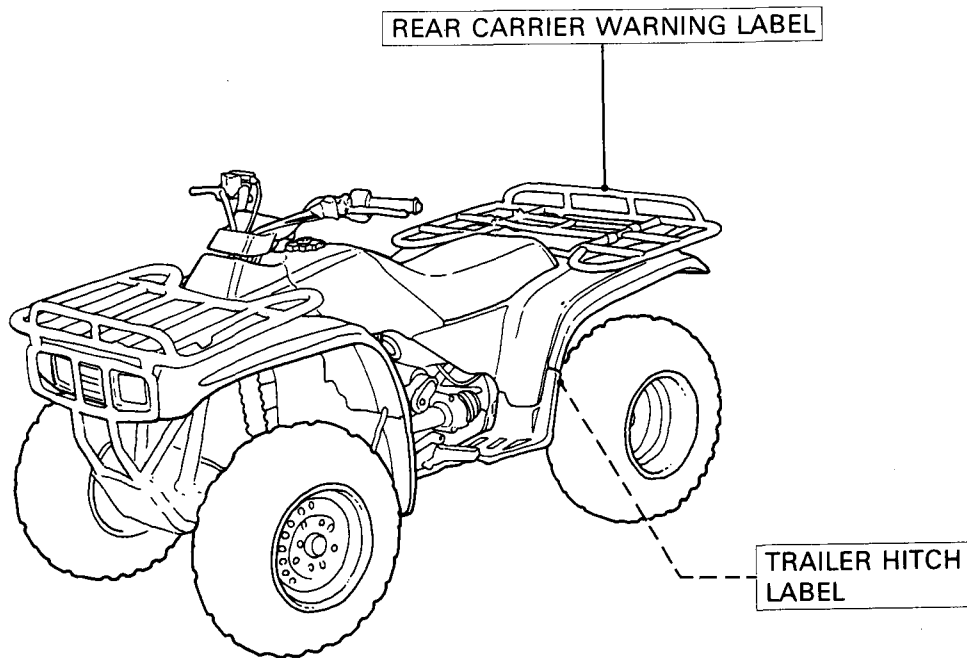

⚠️ WARNING

- * ***BIG RED riding requires special efforts on your part to ensure your safety. Know these requirements before you ride.***
- * ***Avoid riding on paved surfaces as handling can be seriously affected. If it is necessary, ride at reduced speeds and avoid sudden turns.***

SAFE RIDING RULES

- * Always make a pre-ride inspection (page 29) before you ride the BIG RED. You may prevent an accident or equipment damage.
- * Always obey local off road riding laws and regulations.
- * Obtain permission to ride on private property. Avoid posted areas and obey “no trespassing” signs.
- * Do not ride fast on unfamiliar terrain or when visibility is limited. Before riding in a new area, check the terrain thoroughly. Never ride headlong past your limit of visibility. It is sometimes impossible to see obstructions, holes and depressions. Always exercise caution.
- * Your ability to operate the BIG RED safely is largely dependent upon your proper judgement.
- * Maintain a safe distance between your BIG RED and other off road vehicles.
- * Do not ride on or near railroad tracks as it is difficult to hear an approaching train.
- * Do not use the flag pole bracket as a trailer hitch.

- * When you select reverse gear, make sure there are no obstacles or people behind you. When it is safe to proceed, ride slowly.
- * Alcohol, drugs and BIG RED’s don’t mix. Even the smallest amount of alcohol can impair your ability to operate your BIG RED safely. Likewise, drugs, even if prescribed by a physician, can be dangerous while operating a BIG RED. Consult your doctor to be sure it is safe to operate a motor vehicle after taking medication.

PROTECTIVE APPAREL

- * Always wear a helmet. You should also wear a face shield or goggles, boots, gloves and non-snag outer protective clothing.
- * The exhaust system becomes very hot during operation and it remains hot after operation. Never touch any part of the hot exhaust system. Wear clothing that fully covers your legs.

MODIFICATIONS

- * Modification of the BIG RED, or removal of original equipment, may render the vehicle unsafe or illegal.
- * Spark arresters and mufflers are required in most areas. Don’t modify your exhaust system. Remember that excessive noise bothers everyone and creates a bad image for off road vehicles.

POST-RIDE CLEANING AND INSPECTION

Dirt, brush and grass that accumulates during off road riding can conceal damage, reduce engine cooling efficiency and overall vehicle performance. If left near the exhaust system, it could be a fire hazard.

Thoroughly clean the entire vehicle (especially the underbody) after riding. Then, carefully inspect the vehicle for wear or damage, paying special attention to the brakes, tyres, driveshafts/boots, steering and suspension systems. Make sure all fasteners are properly tightened. Replace or repair any part that is damaged. Also, thoroughly clean and inspect the exhaust system, and remove all accumulated debris which could be a fire hazard.

LOADING AND ACCESSORIES

▲ WARNING

- * *To prevent an accident, use extreme care when riding with accessories and cargo. The addition of accessories and cargo can reduce the **BIG RED's** stability, performance, and safe operating speed. Slow down to 10 mph or less when loaded with cargo or pulling a trailer.*

NOTE:

- * These loading capacities apply to standard or Honda optional equipment only.

The combined weight of the rider, cargo, and all accessories must not exceed. **220 kg (485 lbs)** which is the maximum weight capacity.

The following loading and towing capacity data is valid only when the riding terrain is level and flat. For different riding terrains, you must exercise your own judgement to load and ride the **BIG RED** safely because carrying cargo can reduce the ability of the **BIG RED** to operate on slopes or other rough terrain.

Never exceed the loading capacities given here.

1. Load cargo on the rear carrier as far forward as possible. Do not allow cargo to extend beyond the end of rear carrier.

Front carrier **30 kg (66 lbs)**

Rear carrier **60 kg (133 lbs)**

2. When towing a trailer, care should be taken to maintain balance and stability. Place cargo in the trailer so that it will not cause the front wheels to lift off the ground during travel.

Tow weight **383 kg (850 lbs)**

(Trailer plus cargo weight)

Tongue weight **14 kg (30 lbs)**

(Weight on hitch point)

3. When towing a trailer and carrying cargo, the combined tongue weight and rear cargo weight should not exceed 45 kg (100 lbs).
4. Do not obstruct handlebar movement with cargo.
5. Do not ride with a passenger on the front or rear carrier.

This BIG RED is not designed to carry a passenger.

6. Do not place any baggage anywhere on the BIG RED other than the front and rear carrier, otherwise, operating stability and the engine may be adversely affected.

////////////////////////////////////DESCRIPTION////////////////////////////////////

PARTS LOCATION

- (1) Fuel tank cap
- (2) Front brake lever
- (3) Throttle lever
- (4) Ignition switch
- (5) Indicator lamps
- (6) Kickstarter pedal
- (7) Oil filler cap/dipstick
- (8) Brake pedal
- (9) Headlights

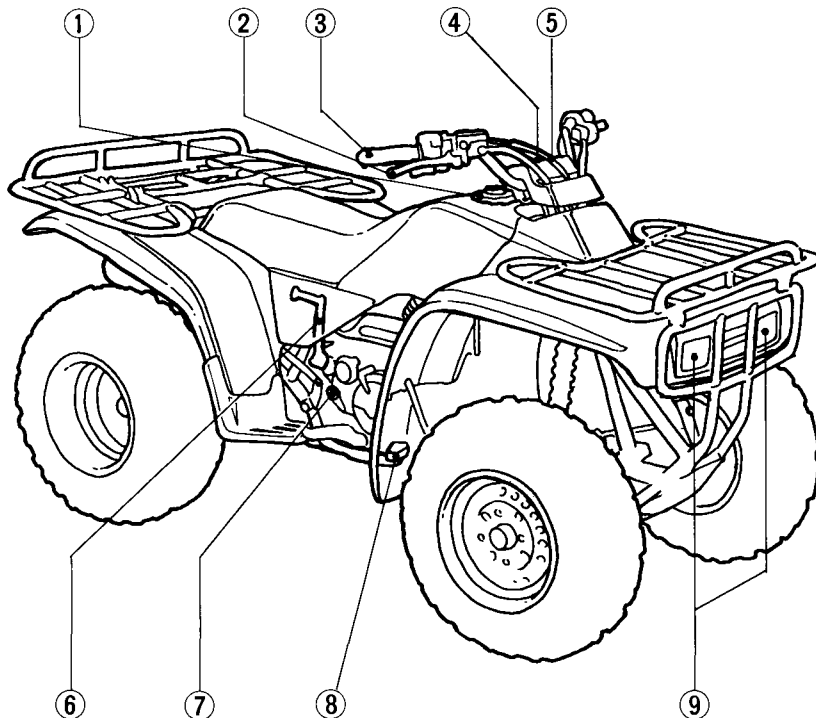

- (10) Helmet holder
- (11) Parking brake lock lever
- (12) Reverse selector knob
- (13) Handlebar switches/choke lever
- (14) Rear brake lever/parking brake
- (15) Tool kit and air pressure gauge
- (16) Storage compartment
- (17) Fuel cock
- (18) Gearshift pedal
- (19) Battery

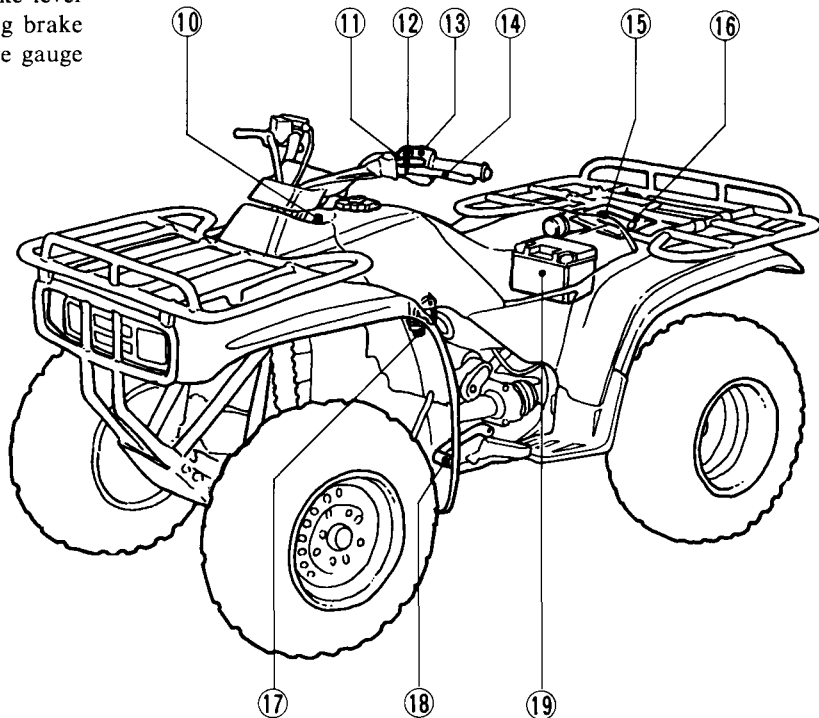

SERIAL NUMBERS

The frame and engine serial numbers are required by your dealer when ordering replacement parts. Record the numbers here for your reference.

The frame serial number (1) is stamped on the front of the frame. The engine serial number (2) is stamped on the right crankcase.

FRAME NO. _____

ENGINE NO. _____

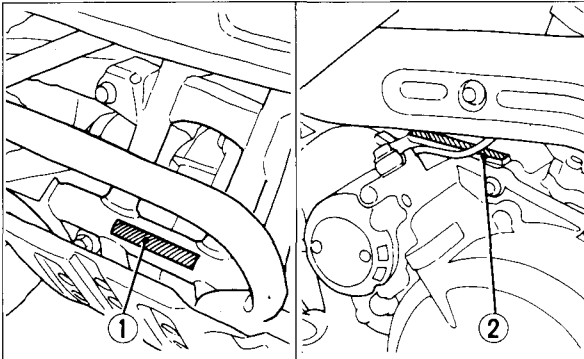

(1) Frame serial number (2) Engine serial number

PARTS FUNCTION

Ignition Switch

The ignition switch (1) is on the handlebar upper holder.

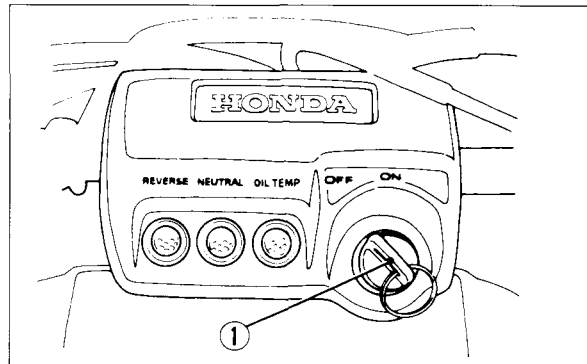

(1) Ignition Switch

Key Position	Function	Key Removal
OFF	Engine and headlights cannot be operated.	The key can be removed.
ON	The headlights can be turned on. With the engine stop switch at RUN and transmission in neutral, the engine can be started.	The key cannot be removed.

Starter Button

The starter button (1) is below the headlight switch. When the starter button is pressed, with the transmission in neutral and the ignition switch on, the starter motor will crank the engine.

Engine Stop Switch

The three position engine stop switch (2) is next to the left handlebar grip. When the switch is in the RUN position, the engine will operate. When the switch is in either OFF position, the engine will not operate. This switch is intended primarily as a safety or emergency switch and should normally remain in the RUN position.

NOTE:

- * If your **BIG RED** is stopped with the ignition switch ON and the engine stop switch OFF, the headlights will still be on, resulting in battery discharge.

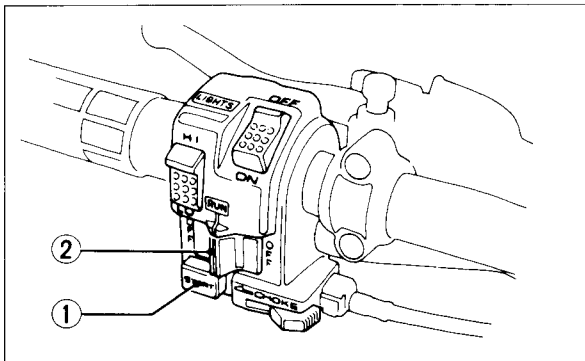

(1) Starter button

(2) Engine stop switch

Headlight and Headlight Dimmer Switches

The headlight (1) and headlight dimmer (2) switches are above the engine stop switch.

Turning the headlight switch ON causes the headlights to light. Select headlight high beam (HI) or low beam (LO) with the dimmer switch.

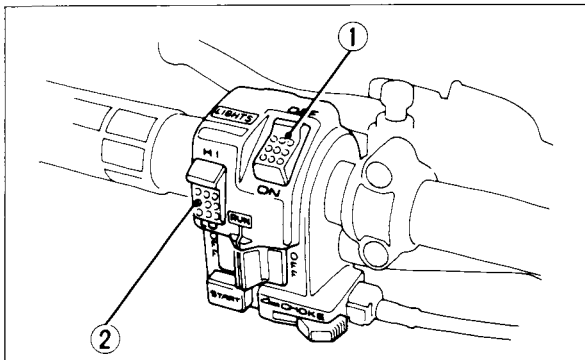

(1) Headlight switch (2) Headlight dimmer switch

Engine Oil Temperature Warning Lamp

When the engine oil temperature becomes too high, the engine oil temperature warning lamp (1) will light. The engine oil temperature warning lamp will light but go off several seconds after turning the ignition switch ON.

CAUTION:

* *If the engine oil temperature warning lamp lights while you are riding, stop the engine immediately and let it cool. Failure to stop the engine immediately will adversely affect the service life of the engine.*

If the warning lamp comes on frequently while riding, have your **BIG RED** inspected by your authorized Honda dealer.

A heavy duty cooling fan is available as an optional part to provide more air flow under adverse conditions.

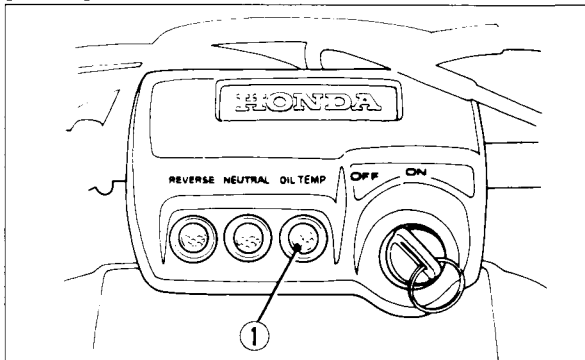

(1) Engine oil temperature warning lamp

CAUTION:

- * *Do not carry or store articles on the front bumper as such practice may restrict air flow through the engine, resulting in engine overheating.*

Reverse Indicator Lamp

This BIG RED is equipped with a reverse indicator lamp (1) to show when the transmission is in reverse. The reverse indicator lamp is on the handlebar cover and will light when the transmission is in reverse with the ignition switch ON.

Neutral Indicator Lamp

This BIG RED is equipped with a neutral indicator lamp (2) to show when the transmission is in neutral. The neutral indicator lamp is on the handlebar cover and will light when the transmission is in neutral with the ignition switch ON.

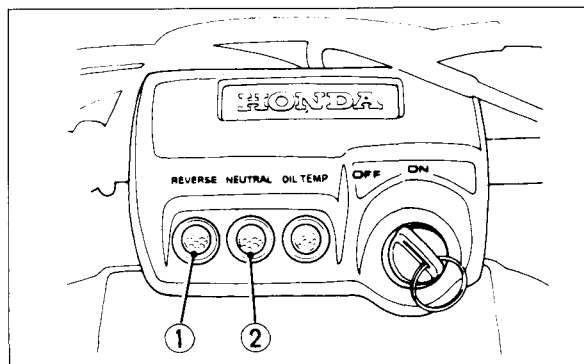

(1) Reverse indicator lamp (2) Neutral indicator lamp

Throttle Lever

The throttle lever (1) is next to the right handlebar grip and is operated by the rider's thumb. Pressing the lever forward opens the throttle. When the lever is released, spring tension closes the throttle automatically.

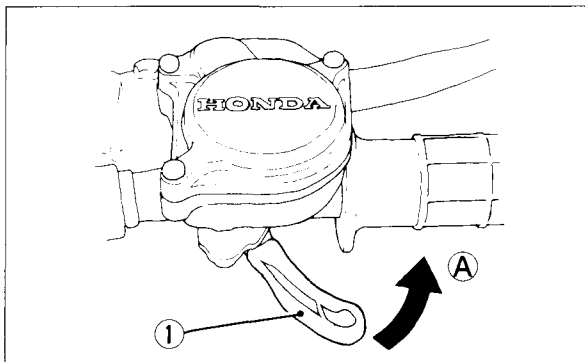

(1) Throttle lever

(A) Open

Choke Lever

The choke lever (1) is next to the left handlebar grip. While pushing it in, move the choke lever to the left for starting the engine when cold. Move the lever to the right as the engine attains normal operating temperature.

To restart a warm engine, it is not necessary to use the choke.

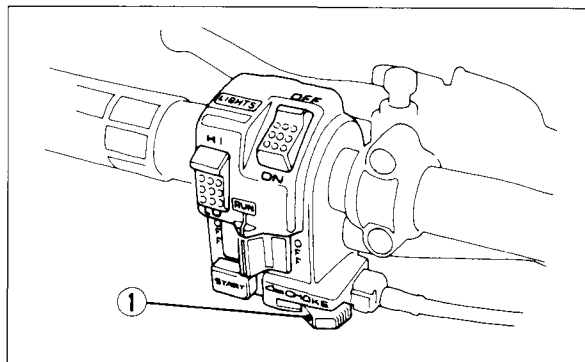

(1) Choke lever

Rear Brake Lever/Parking Brake

The front brakes are operated by the right hand brake lever. The rear brake lever (1) and the brake pedal both operate the rear brake. Either one can be used to brake the **BIG RED**. The rear brake lever has the added feature of a lock (2) which allows the lever to be used as a parking brake.

Pull the rear brake lever back and lock it with the lock lever. Always apply the parking brake when parking the **BIG RED** and when starting the engine.

The parking brake is unlocked by squeezing the rear brake lever.

NOTE:

* Use of the parking brake in freezing weather may cause the brakes to freeze in the locked position.

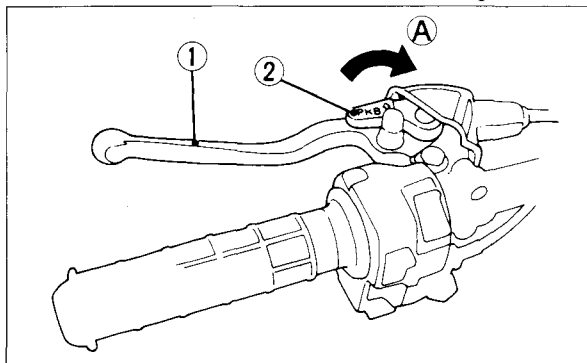

(1) Rear brake lever/Parking brake (2) Lock lever
(A) Lock

Reverse Selector Knob

The reverse selector knob (1) is on the rear brake lever (2).

When shifting the transmission into reverse, bring the **BIG RED** to a complete stop, push the reverse selector knob in and squeeze the rear brake lever.

The transmission will be shifted into reverse by depressing the gearshift pedal.

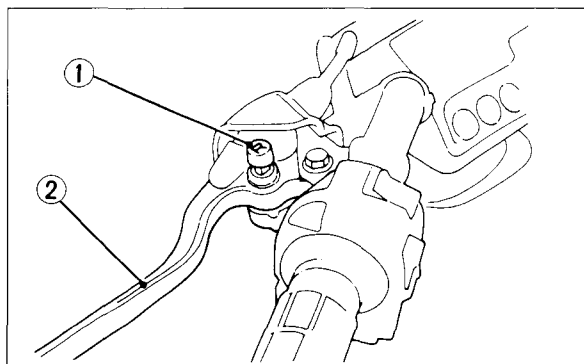

(1) Reverse selector knob (2) Rear brake lever

Helmet Holder

The helmet holder (1) is located on the left side of the fork bridge. To use the helmet holder, hang your helmet on the holder by the D-ring.

⚠ WARNING

** Do not operate the BIG RED with a helmet attached to the holder; your ability to steer will be impaired. The helmet holder is designed for use only while the BIG RED is parked.*

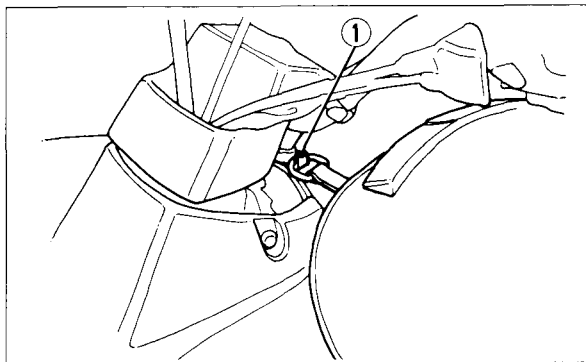

(1) Helmet holder

Storage Compartment

The storage compartment (1) is behind the seat. Unhook the stopper rubbers (2) to open the carrier (3) and storage compartment. The owner's manual (4), tool kit (5) and air pressure gauge (6) should be stored in the storage compartment.

When washing your BIG RED or riding through water, be careful not to flood this area with water.

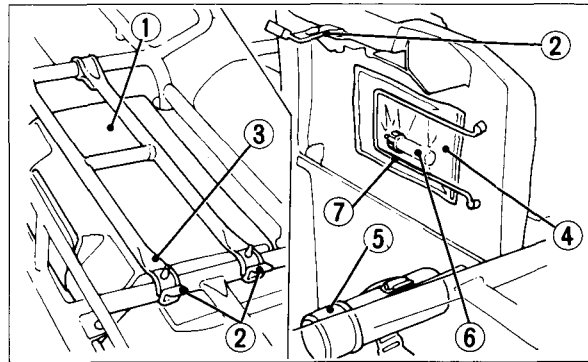

(1) Storage compartment (4) Owner's manual
(2) Stopper rubber (5) Tool kit
(3) Carrier (6) Air pressure gauge
(7) Manual holder

Seat Removal

1. Release the seat lock by pulling up the seat lock lever (1) at the left side of the seat.
2. Remove the seat (2) by lifting it upward.

Installation:

1. Insert the front prong (3) into the recess (4) and the rear studs (5) into the rubber mounts (6).
2. Secure the seat by pressing down until it locks.

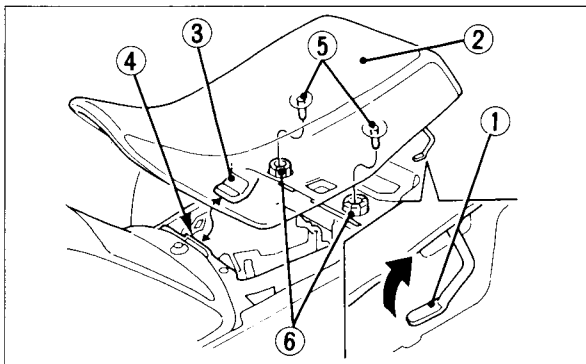

- | | |
|---------------------|-------------------|
| (1) Seat lock lever | (4) Recess |
| (2) Seat | (5) Rear studs |
| (3) Front prong | (6) Rubber mounts |

12V DC Power Supply

The direct current receptacle (1) is on the right side of the headlight. It provides 12V DC power at a maximum of 60 watts (5 Amps). The specified fuse is 15A.

⚠ WARNING

* *Never use a fuse with a different rating from that specified. Serious damage to the electrical system or a fire could result.*

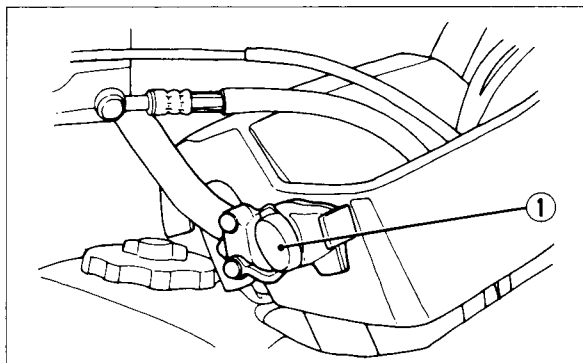

- (1) 12V DC Receptacle